



AUTOLIFT<sup>TM</sup>



TWIN-ARM LIFTS

## WELCOME TO AUTOLIFT

Autolift S.r.l. is a young, dynamic company. With twenty years of experience in the lifting sector, the company has specialized in the production of equipment for wheelchair accessibility. Thanks to highly specialized staff, cutting-edge technologies and full range of products, Autolift S.r.l. can meet the market demand for motor vehicle outfitting to serve both private and public use clients.

The company's mission focuses on:

- Ongoing research to find the best solutions to eliminate the barriers to access and transport for people with disabilities.
- Development and engineering of special devices to cover the full range of requirements from our global clientele.
- Produce aids that comply with current regulations concerning the disabled, first aid and public transport.
- Offer prompt, efficient support that enables installers to provide their customers with impeccable service both during installation and after-sales (warranty, spare parts, support).
- An offering that can even meet the needs of people with disabilities to board trains, ships and aircraft as per European regulations.
- Compliance of all our products with CE markings and regulations on electromagnetic compatibility. Each product, whether a lift or access step, comes not only with the relative manuals, but also with certificates of origin and conformity.

*“There’s a multitude of ways to lift something, the key is how you lift it.  
Autolift... The lifts”*

Our internal lifts are completely automatic, twin-arm tail-lifts, which are fastened internally to the vehicle floor. These devices are suitable for side or rear installation, depending on the type of product and vehicle to be converted.

In this catalogue you will find:

#### **Steel twin-arm lifts ONDA Series**

---

Page 04-05 OB Series One-piece Platform  
Page 06-07 OS Series Horizontally Folding Platform  
Page 08-09 OW Series Vertically Folding Platform

#### **Steel twin-arm lifts BB Series**

---

Page 10-11 BB Series One-piece Platform  
Page 12-13 SKY Series Horizontally Folding Platform  
Page 14-15 BBW Series Vertically Folding Platform

#### **Aluminum twin-arm lifts PIUMA Series**

---

Page 16-17 Presentation of PIUMA Series  
Page 18-19 BAI Series One-piece Platform  
Page 20-21 BAS Series Horizontally Folding Platform

### THE EFFICIENT AND COMFORTABLE WHEELCHAIR LIFT WITH SOLID PLATFORM



## ONDA OB Series

The compact and robust solution for heavy duty use

- Efficiency** Consuming 30% less energy, ONDA is the most efficient lift available.
- Stability** ONDA's patented unique structure is stiffer than competing systems providing the customer with stability.
- Design** In addition to providing best in class aesthetic design, ONDA offers a more space efficient structure.
- Comfort** Onda achieves unrivalled comfort when equipped with its optional platform lighting system and the lowering speed control which dramatically reduces start-up accelerations.

#### OB SPECIFICATIONS

- Solid platform
- Powder Coating
- Two-buttons control unit
- Reduced base plate height
- Automatic roll-stop plate
- Automatic bridging plate
- Auxiliary pump and lowering valve
- Automatic extendible handrails
- EMC tested
- EC Standards compliant
- Crash tested
- Weather Conditions Tested

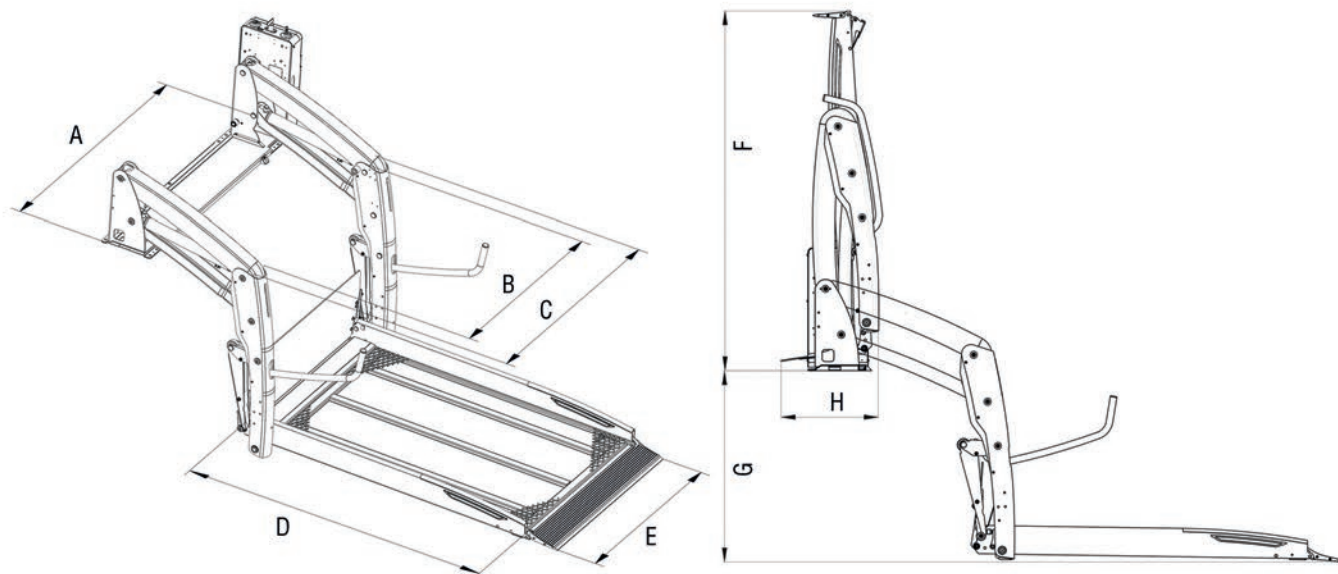

#### Technical Features

	Baseplate width	Clear entry width	Traveling frame width	Overall platform length	Overall platform width	Overall lift height	Max loading height	Overall lift depth	Rated load capacity (Kg)	Lift weight (Kg)
	A	B	C	D	E	F	G	H		
OB 1350	1178	876	1060	1330	815	1468	800	335	400	148
OB 1402	1276	976	1153	1380	910	1521	800	300	400	145

## THE EFFICIENT AND COMFORTABLE WHEELCHAIR LIFT WITH HORIZONTAL FOLDING PLATFORM



### ONDA OS Series

The Autolift solution to stow a large platform in a low roof vehicle, providing a good rear visibility

- Efficiency** Consuming 30% less energy, ONDA is the most efficient lift available.
- Stability** ONDA's patented unique structure is stiffer than competing systems providing the customer with stability.
- Design** In addition to providing best in class aesthetic design, ONDA offers a more space efficient structure.
- Comfort** Onda achieves unrivalled comfort when equipped with its optional platform lighting system and the lowering speed control which dramatically reduces start-up accelerations.

#### OS SPECIFICATIONS

- Horizontally folding platform
- Powder coating
- Two-buttons control unit
- Reduced base plate height
- Automatic roll-stop plate
- Automatic bridging plate
- Auxiliary pump and lowering valve
- Automatic extendible handrails
- EMC tested
- EC standards compliant
- Crash tested
- Weather conditions tested

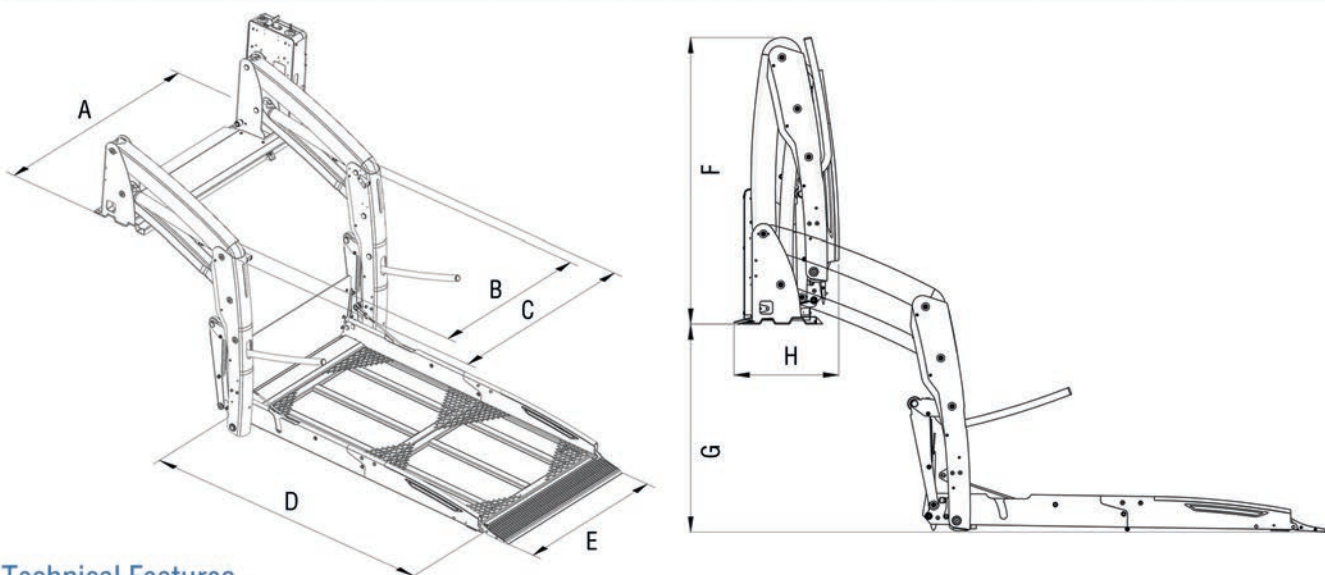

#### Technical Features

	Baseplate width		Clear entry width		Traveling frame width		Overall platform length		Overall platform width		Overall lift height		Max loading height		Overall lift depth		Rated load capacity (Kg)		Lift weight (Kg)	
	A	B	C	D	E	F	G	H												
OS 1150	1076	772	958	1130	710	1107	800	367	400	122										
OS 1395	1180	876	1062	1380	815	1107	800	367	400	149										
OS 1495	1180	876	1062	1480	815	1107	800	370	400	155										
OS 1500	1270	966	1152	1480	900	1107	800	370	400	160										

## THE EFFICIENT AND COMFORTABLE WHEELCHAIR LIFT WITH VERTICALLY FOLDING PLATFORM



### ONDA OW Series

The Autolift solution to provide easy access and good visibility

<b>Efficiency</b>	Consuming 30% less energy, ONDA is the most efficient lift available.
<b>Stability</b>	ONDA's patented unique structure is stiffer than competing systems providing the customer with stability.
<b>Design</b>	In addition to providing best in class aesthetic design, ONDA offers a more space efficient structure.
<b>Comfort</b>	Onda achieves unrivalled comfort when equipped with its optional platform lighting system and the lowering speed control which dramatically reduces start-up accelerations.

#### OW SPECIFICATIONS

- Vertically folding platform
- Powder Coating
- Two-buttons control unit
- Reduced base plate height
- Automatic roll-stop plate
- Automatic bridging plate
- Auxiliary pump and lowering valve
- Automatic extendible handrails
- EMC tested
- EC Standards compliant
- Crash tested
- Weather Conditions Tested

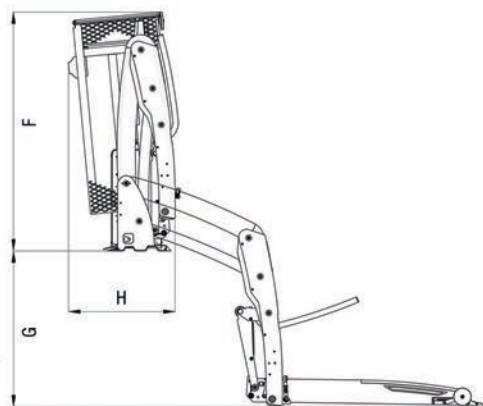
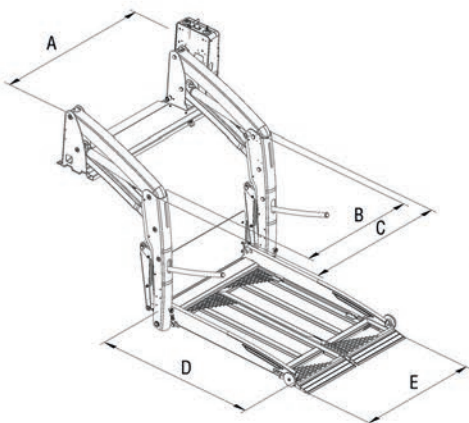

#### Technical Features

	Baseplate width		Clear entry width		Traveling frame width		Overall platform length		Overall platform width		Overall lift height		Max loading height		Overall lift depth		Rated load capacity (Kg)		Lift weight (Kg)	
	A	B	C	D	E	F	G	H												
OW 1060	1074	772	956	1060	710	1174	800	514	400	126										
OW 1100	1177	876	1062	1110	815	1222	800	570	400	145										
OW 1320	1177	876	1062	1330	815	1442	800	572	400	155										

## LIFTS WITH ONE-PIECE PLATFORM

Uniquely robust and reliable



### SAFETY DEVICES

- Front roll-stop stop plate on the automatic loading platform
- Rear roll-stop stop plate on the automatic loading platform
- Anti-tilting control valve
- Automatic extendable/retractable handrails

### EMERGENCY

- Emergency operation lift via auxiliary hydraulic pump
- Emergency descent by unlocking descent valve

**ALSF**  
AUTOLIFT SPACE FRAME

The automatic, twin-arm, electro-hydraulic lifts in the **BB** Series have a one-piece platform. Thanks to a two-button control unit and the use of top quality materials, these devices are not only user friendly, they are also extremely reliable. Available in a wide range of sizes, they can be internally rear or side mounted in a wide variety of people carriers.

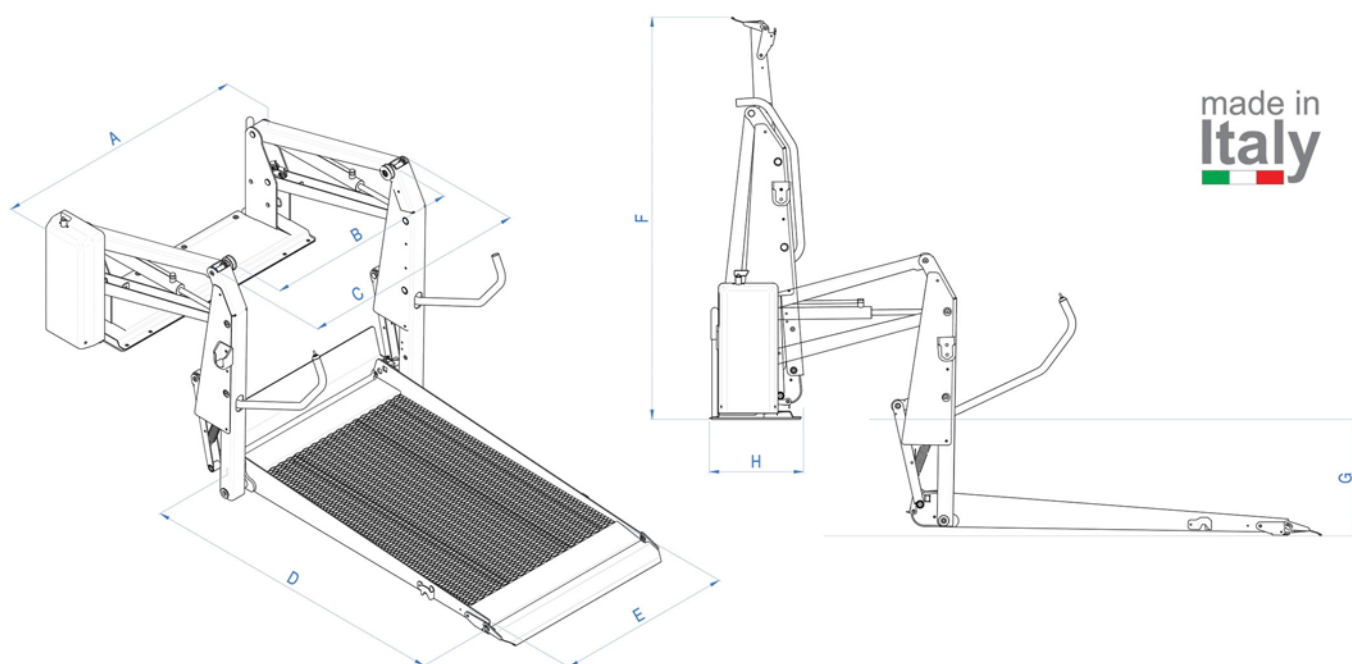

## Technical Features

	Baseplate width	Clear entry width	Traveling frame width	Overall platform length	Overall platform width	Overall lift height	Max loading height	Overall lift depth	Rated load capacity (Kg)	Lift weight (Kg)
	A	B	C	D	E	F	G	H		
BB 1050	1165	880	1030	1050	800	1110	920	350	350	148
BB 1350	1165	880	1030	1350	800	1400	920	350	350	153

### Series BB Technical Features

Movement powered by two hydraulic cylinders  
 One-piece folding platform with anti-slip surface  
 Anti-rust powder paint coating  
 Self-lubricating bushings and pins

Two-button control unit  
 12-24V Electrical System  
 For use at temperatures between -30°C and +70°C  
 Valid EMC accreditation (E50)  
 EC standard compliant

## LIFTS WITH HORIZONTALLY FOLDING PLATFORM

### The importance of good rear visibility



#### SAFETY DEVICES

- Front safety roll stop on the automatic loading platform
- Rear safety roll stop on the automatic loading platform
- Anti-tilting control valve
- Automatic extendable/retractable handrails

#### EMERGENCY

- Emergency operation lift via auxiliary hydraulic pump
- Emergency descent by unlocking descent valve



**ALSF**  
AUTOLIFT SPACE FRAME

The automatic, twin-arm, electro-hydraulic lifts in the **SKY** Series have a horizontally folding platform. Thanks to a two-button control unit and the use of top quality materials, these devices are not only user friendly, they are also extremely reliable. Available in a wide range of sizes, they can be internally rear and side mounted in a wide variety of people carriers, whilst ensuring good visibility.

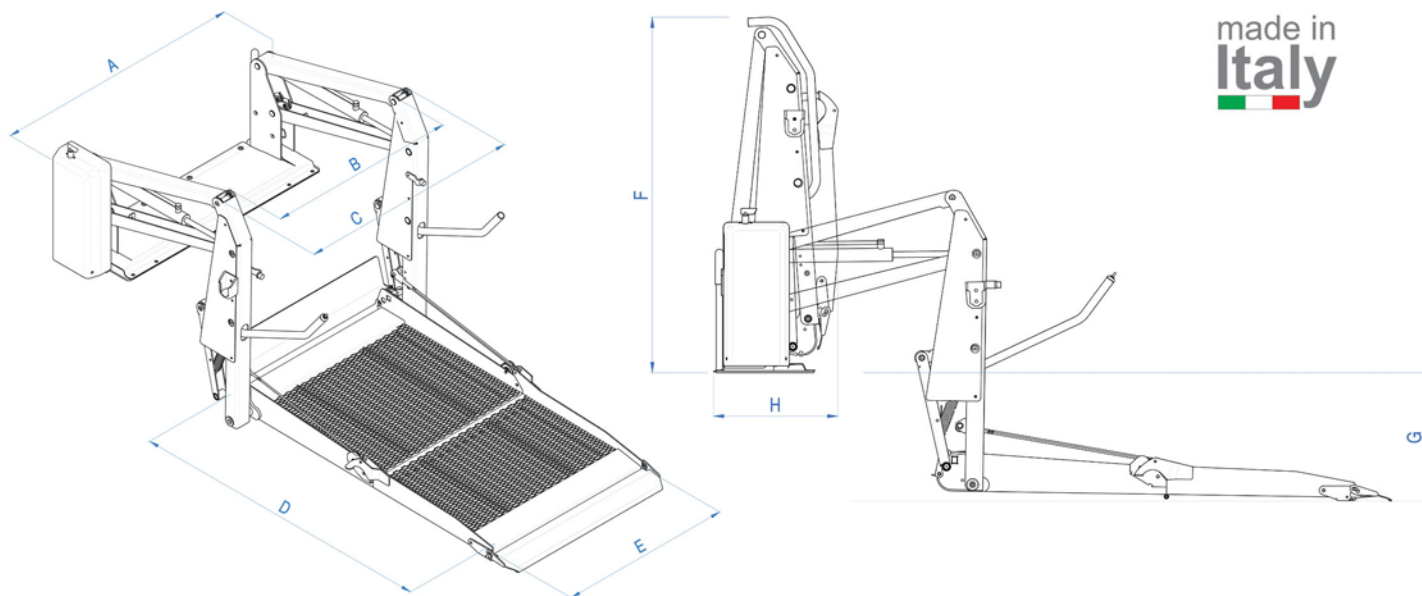

made in  
**Italy**

## Technical Features

		Baseplate width	Clear entry width	Traveling frame width	Overall platform length	Overall platform width	Overall lift height	Max loading height	Overall lift depth	Rated load capacity (Kg)	Lift weight (Kg)
		A	B	C	D	E	F	G	H		
BBSL	1150	1085	790	940	1150	720	1130	880	350	320	122
BBS	1395	1165	880	1030	1400	800	1220	920	370	350	156

### Series SKY BBS Technical Features

Movement powered by two hydraulic cylinders  
 Horizontally folding platform with anti-slip surface  
 Anti-rust powder paint coating  
 Self-lubricating bushings and pins

Two-button control unit  
 12-24V Electrical System  
 For use at temperatures between -30°C and +70°C  
 Valid EMC accreditation (E60)  
 EC standard compliant

## LIFTS WITH VERTICALLY FOLDING PLATFORM

Easy access and good visibility



### SAFETY DEVICES

- Front safety roll stop on the automatic loading platform
- Rear safety roll stop on the automatic loading platform
- Anti-tilting control valve
- Automatic extendable/retractable handrails

### EMERGENCY

- Emergency operation lift via auxiliary hydraulic pump
- Emergency descent by unlocking descent valve

**ALSF**  
AUTOLIFT SPACE FRAME

The automatic, twin-arm, electro-hydraulic lifts in the **BBW** Series have a vertically folding platform. Thanks to a two-button control unit and the use of top quality materials, these devices are not only user friendly, they are also extremely reliable. Available in a wide range of sizes, they can be internally rear and side mounted in a wide variety of people carriers. These devices are unusual, as they not only guarantee good visibility, but also provide an additional access point.

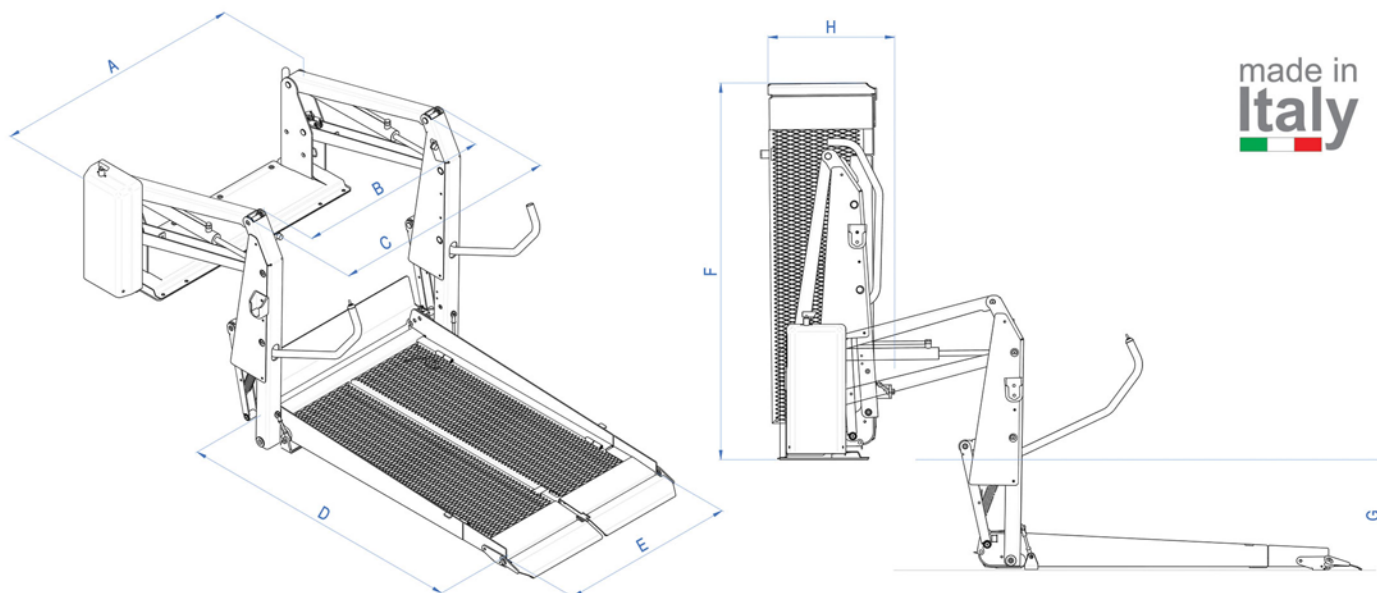

## Technical Features

	Baseplate width	Clear entry width	Traveling frame width	Overall platform length	Overall platform width	Overall lift height	Max loading height	Overall lift depth	Rated load capacity (Kg)	Lift weight (Kg)
	A	B	C	D	E	F	G	H		
BBWM 905	970	690	840	915	645	1020	690	420	320	108
BBWL 1030	1085	790	940	1030	745	1180	880	485	320	126

### Series BBW Technical Features

Movement powered by two hydraulic cylinders  
 Vertically folding platform with anti-slip surface  
 Anti-rust powder paint coating  
 Self-lubricating bushings and pins

Two-button control unit  
 12-24V Electrical System  
 For use at temperatures between -30°C and +70°C  
 Valid EMC accreditation (E50)  
 EC standard compliant

- Modern Design
- No Corrosion
- Flashing Lights integrated in the Arms
- Weight reduced up to 50%
- Increased Payload (1 more seat)
- Lower Fuel Consumption
- Environment Friendly through reduced CO2 Emissions
- Vehicle Improved Stability



**ALSF**  
AUTOLIFT SPACE FRAME

Patents Pending

Lighter than



Lower fuel  
consumption



Environment  
friendly



100%  
recyclable



made in  
**Italy**



All car producers advice not to carry unnecessary loads in vehicle in order to reduce fuel consumption.

From our research we can estimate that the reduced weight of the PIUMA Lift can help to reduce the fuel consumption up to **0,3 lt/100km**.

**On this base we can calculate following savings:**

## FUEL SAVING (Diesel Engines)

Year	Saving 10.000 Km / Year	20.000 Km / Year	30.000 Km / Year
1	45	90	135
2	90	180	270
3	135	270	405
4	180	360	540
5	225	450	675
6	270	540	810
7	315	630	945
8	360	720	1080
9	405	810	1215
10	450	900	1350
<b>Total</b>	<b>450 Euro</b>	<b>900 Euro</b>	<b>1350 Euro</b>

## Reduction of CO2 Emission (1lt Diesel fuel = 2.650 g)

Year	Reduction by 10.000 Km / Year	20.000 Km / Year	30.000 Km / Year
1	79.500 g	159.000 g	238.500 g
2	159.000 g	318.000 g	477.000 g
3	238.500 g	477.000 g	715.000 g
4	318.000 g	636.000 g	954.000 g
5	397.000 g	795.000 g	1.192.500 g
6	477.000 g	954.000 g	1.431.000 g
7	556.500 g	1.113.000 g	1.669.500 g
8	636.000 g	1.272.000 g	1.908.000 g
9	715.500 g	1.431.000 g	2.146.500 g
10	795.000 g	1.590.000 g	2.380.500 g
<b>Total</b>	<b>795.000 g</b>	<b>1.590.000 g</b>	<b>2.380.000 g</b>

## ALUMINUM LIFTS WITH A ONE-PIECE PLATFORM

### Lightweight yet robust



#### SAFETY DEVICES

- Anti-tilting control valve
- Front safety roll-stop on the automatic loading platform
- Rear safety roll-stop on the automatic loading platform
- Automatic extendable/retractable handrails

#### EMERGENCY

- Emergency operation lift via auxiliary hydraulic pump
- Emergency descent by unlocking descent valve



**ALSF**  
AUTOLIFT SPACE FRAME

The electro-hydraulic lifts in the **BAI Series** have automatic, aluminum twin-arms and horizontal platform. Thanks to a two-button control unit and the use of top quality materials, these devices are not only user friendly, they are also extremely reliable. Available in a wide range of sizes, they can be internally rear or side mounted in a wide variety of people carriers. The aluminum structure of BAI lifts is completely corrosion proof and its light weight construction ensures considerable fuel saving, whilst remaining sturdy and reliable.

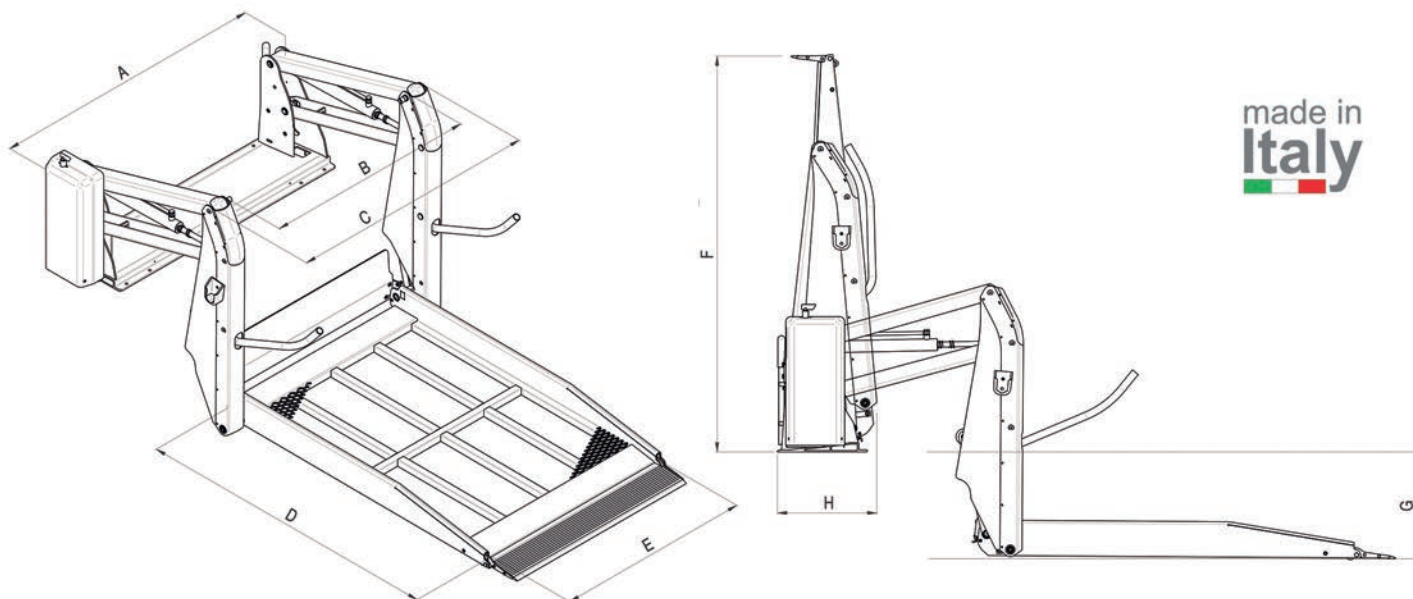

Lower fuel  
consumption



Environment  
friendly



## Technical Features

	Baseplate width		Clear entry width		Traveling frame width		Overall platform length		Overall platform width		Overall lift height		Max loading height		Overall lift depth		Rated load capacity (Kg)		Lift weight (Kg)	
	A	B	C	D	E	F	G	H												
BAI 1401	1290	975	1145	1400	900	1525	920	370	350	104										
BAI 1402	1290	975	1145	1400	900	1510	880	295	350	106										

### Series BAI

#### Technical specifications

Movement powered by two hydraulic cylinders  
Anti-rust powder paint coating  
100% corrosion and rust proof  
Self-lubricating bushings and pins

All aluminum, one-piece platform with anti-slip surface  
Two-button control unit  
12-24V Electrical System  
For use at temperatures between -30°C and +70°C  
Valid EMC accreditation (E50)  
EC standard compliant

### ALUMINUM LIFTS WITH HORIZONTALLY FOLDING PLATFORM

Lightweight plus good visibility



#### SAFETY DEVICES

- Anti-tilting control valve
- Front safety roll-stop on the automatic loading platform
- Rear safety roll-stop on the automatic loading platform
- Automatic extendable/retractable handrails

#### EMERGENCY

- Emergency operation lift via auxiliary hydraulic pump
- Emergency descent by unlocking descent valve



**ALSF**  
AUTOLIFT SPACE FRAME

The electro-hydraulic lifts in the **BAS Series** have automatic, aluminum twin-arms and horizontally foldable platform. Thanks to a two-button control unit and the use of top quality materials, these devices are not only user friendly, they are also extremely reliable. Available in a wide range of sizes, they can be internally rear or side mounted in a wide variety of people carriers. The aluminum structure of BAS lifts is completely corrosion proof and its light weight ensures considerable fuel saving, whilst remaining sturdy and reliable.

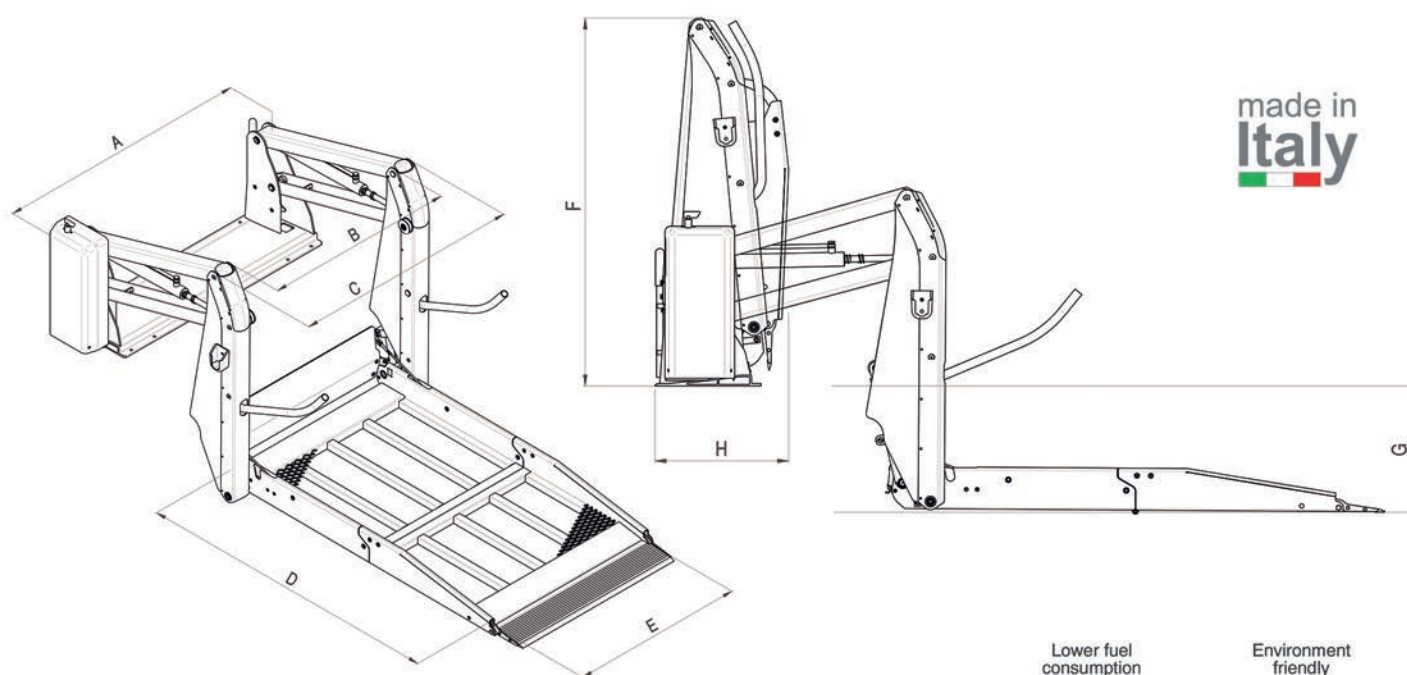

Lower fuel  
consumption



Environment  
friendly



## Technical Features

	Baseplate width		Clear entry width		Traveling frame width		Overall platform length		Overall platform width		Overall lift height		Max loading height		Overall lift depth		Rated load capacity (Kg)		Lift weight (Kg)	
	A	B	C	D	E	F	G	H												
BAS 1395	1190	875	1045	1400	800	1190	920	450	350	109										

### Series BAS Technical specifications

Movement powered by two hydraulic cylinders  
Anti-rust powder paint coating  
100% corrosion and rust proof  
Self-lubricating bushings and pins

All-aluminum, horizontally folding platform with  
anti-slip surface  
Two-button control unit  
12-24V Electrical System  
For use at temperatures between -30°C and +70°C  
Valid EMC accreditation (E50)  
EC standard compliant

# WHERE WE ARE

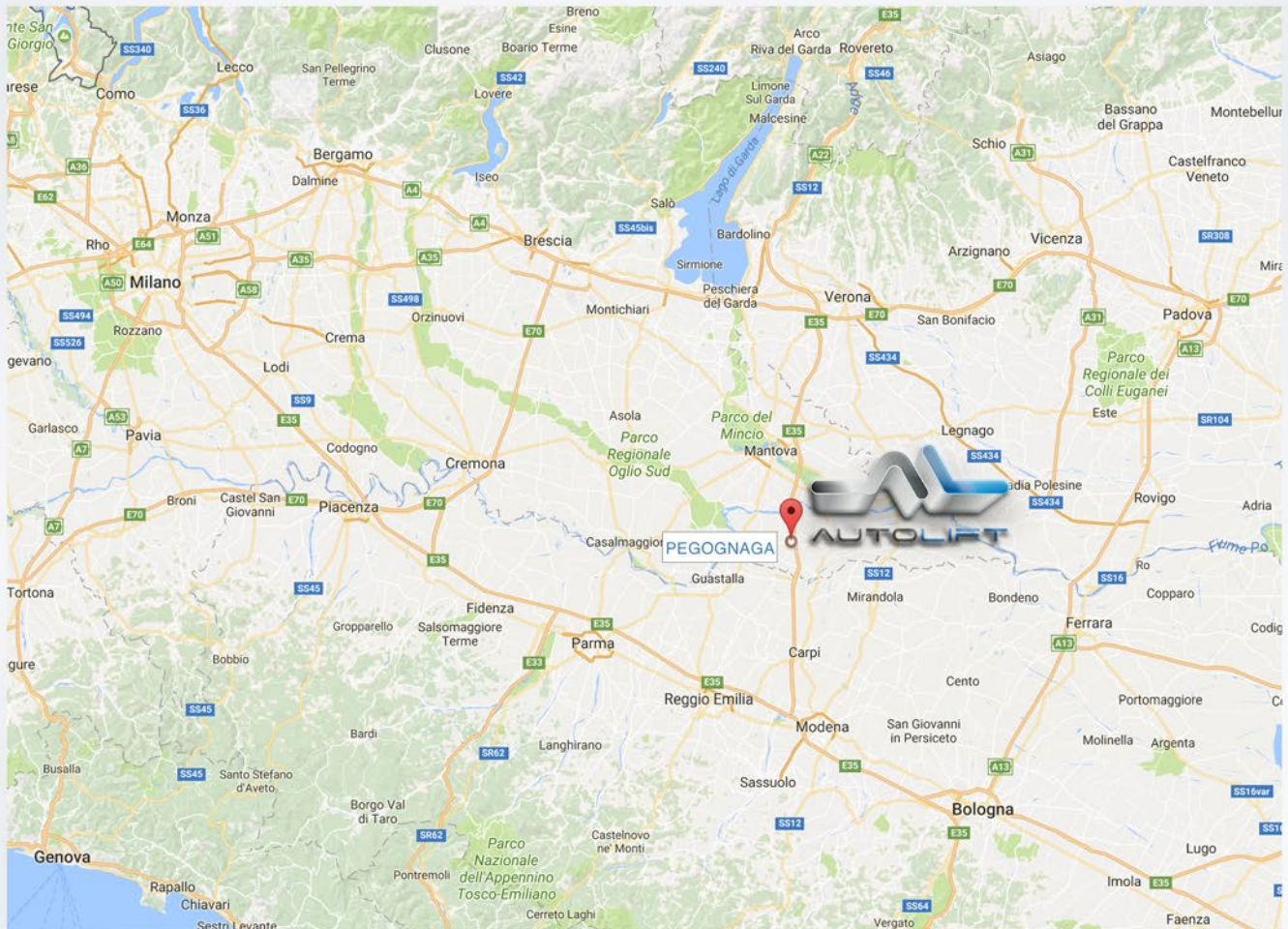

Autolift S.r.l. is the leading Italian manufacturer of lifts, steps and assistance equipment for the transportation of disabled persons. All products are **MADE IN ITALY** and are marketed nationwide and throughout Europe. Our factory is located in Mantua, near the Pegognaga highway exit.

AUTOLIFT S.r.l.

Via B. Trentin, 8 - 46020 Pegognaga (MN)

Tel. +39 0376 550375 - Fax +39 0376 553728 - E-mail [info@autoliftsrl.com](mailto:info@autoliftsrl.com)

[www.autoliftsrl.com](http://www.autoliftsrl.com)